

PASSARELA

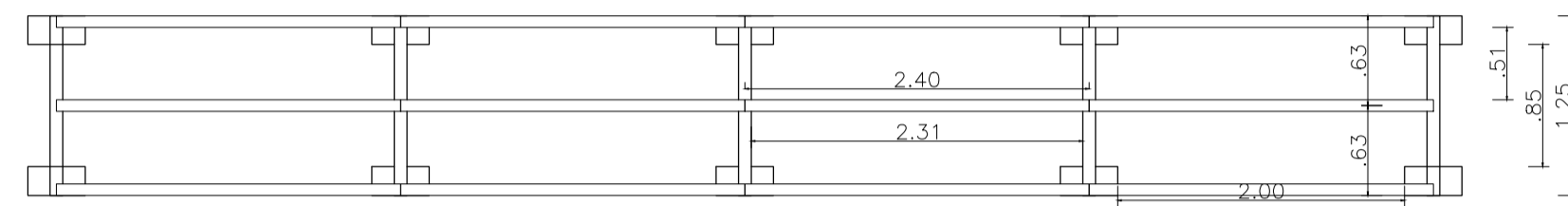

PLANTA BAIXA
Esc: 1/50

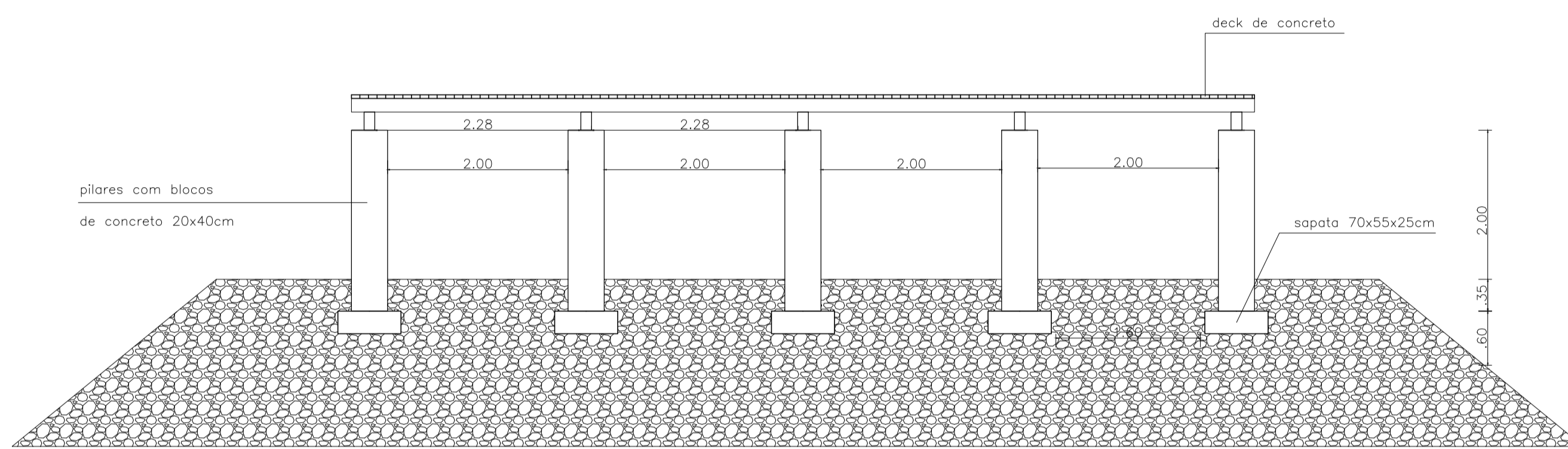

CORTE - PILARES INFERIORES
Esc: 1/50

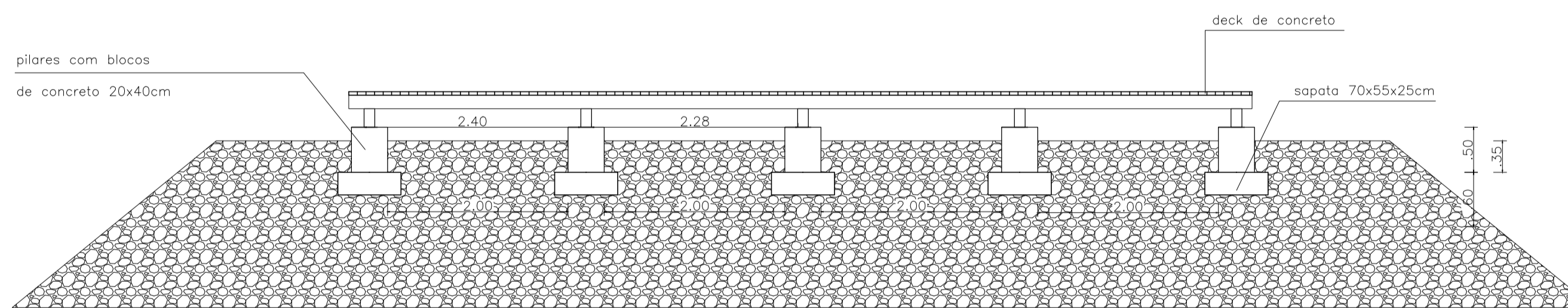

CORTE - PILARES SUPERIORES
Esc: 1/50

MIRANTE

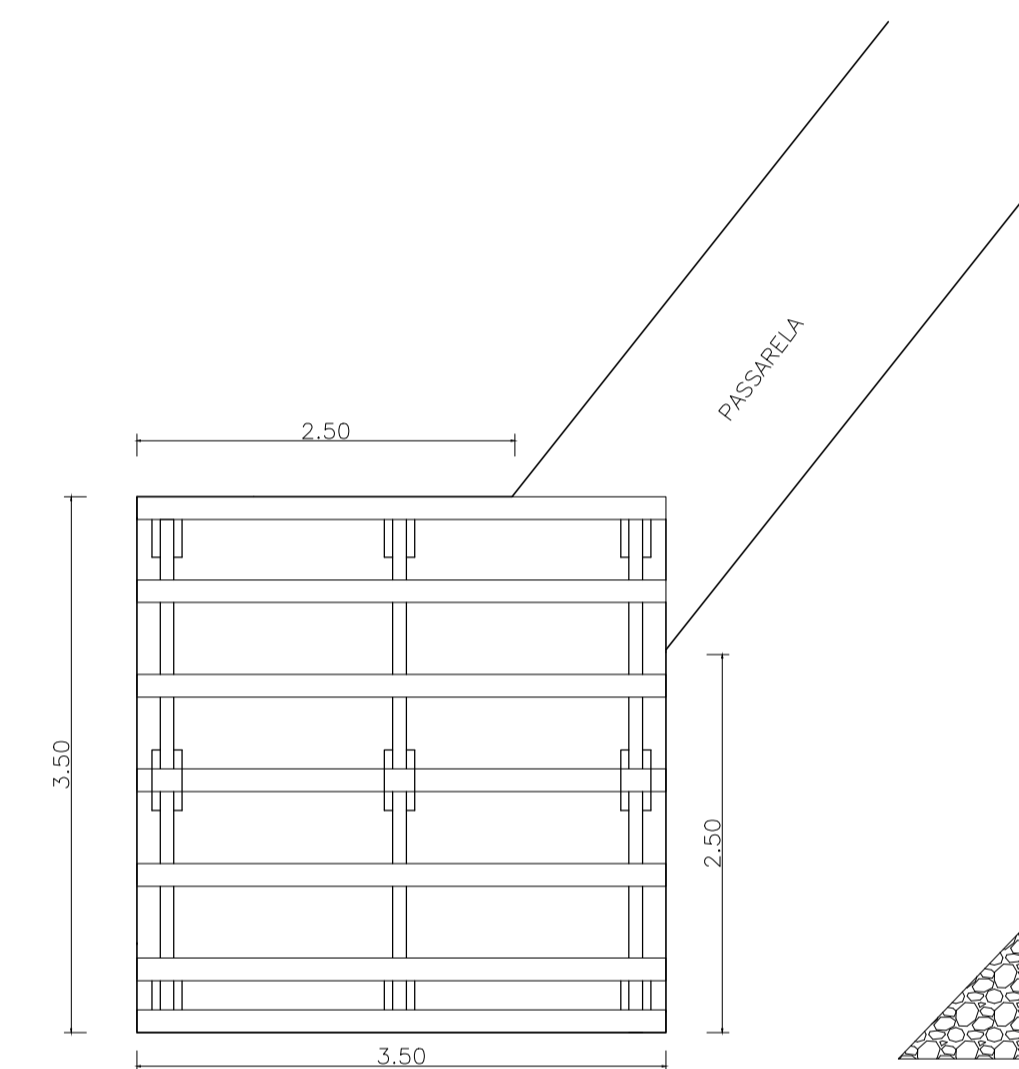

PLANTA BAIXA
Esc: 1/50

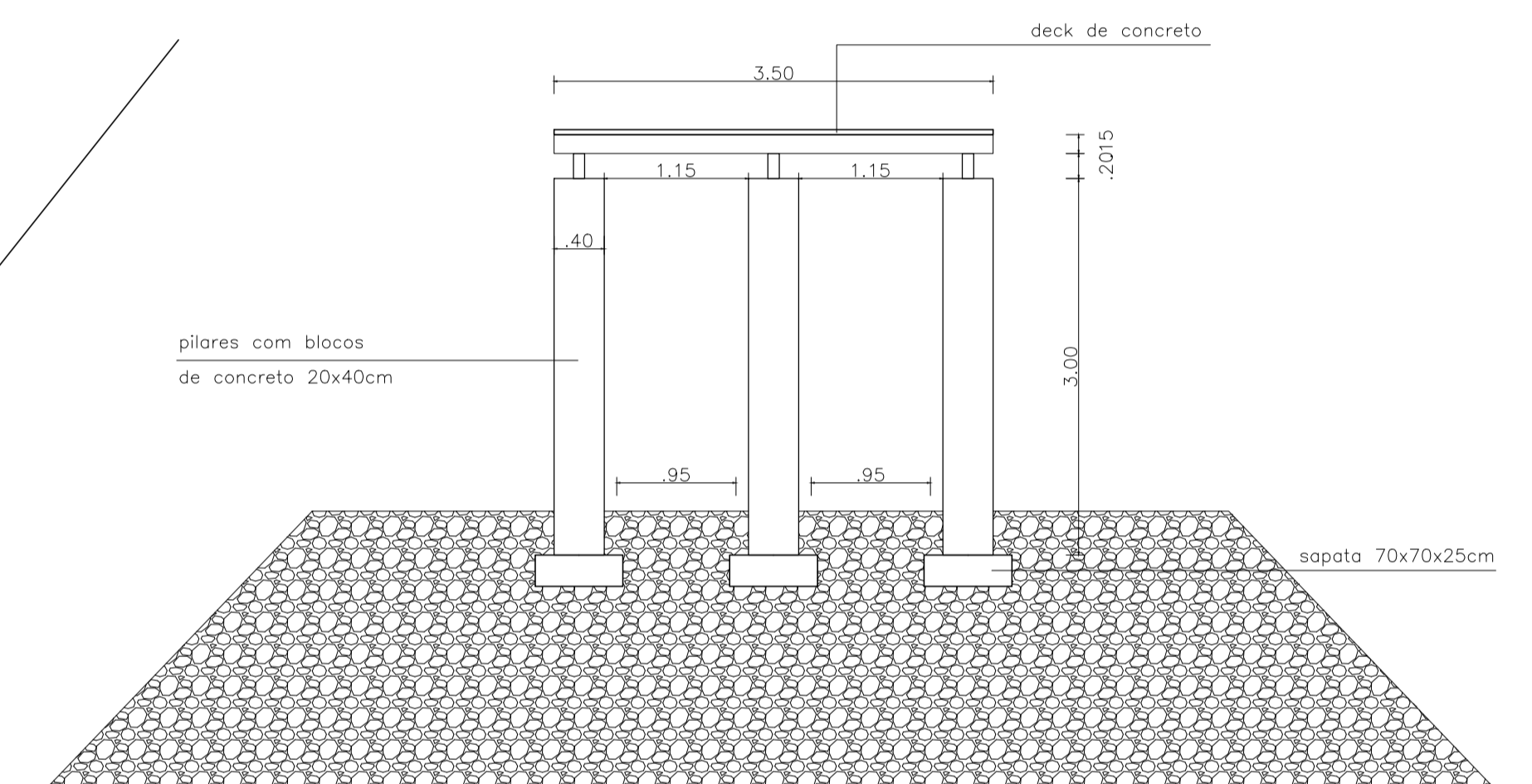

CORTE
Esc: 1/50

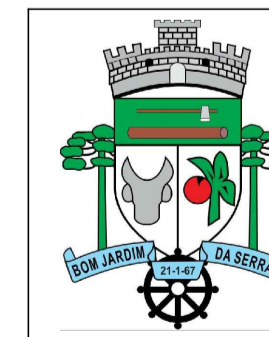

PREFEITURA DE BOM JARDIM DA SERRA

Projeto de Revitalização

MIRANTE DA CASCATA
SC-390 | Bom Jardim da Serra / SC

Projeto:
Arquitetônico

Descrição:
Detalimentos - Passarela e Deck

Escala: indicada
Data: Agosto | 2022

Responsável Técnica: Jennifer Herholz
Arquiteta e Urbanista - CAU | RS A156110-3